

est 1979

Jeremy
Leaf & Co.



est 1979
Jeremy
Leaf & Co.



Edmunds Walk, London, N2 0HU

£675,000

- Secondary Glazed Windows
- Large Kitchen/Diner
- Three Bedrooms
- Lease 999 Years from 27/11/2003
- Garage
- Gas Central Heating
- Chain Free
- Kitchen/Diner

98 High Road, London, N2 9EB
020 8444 5222

eastfinchley@jeremyleaf.co.uk
<https://www.jeremyleaf.co.uk/>

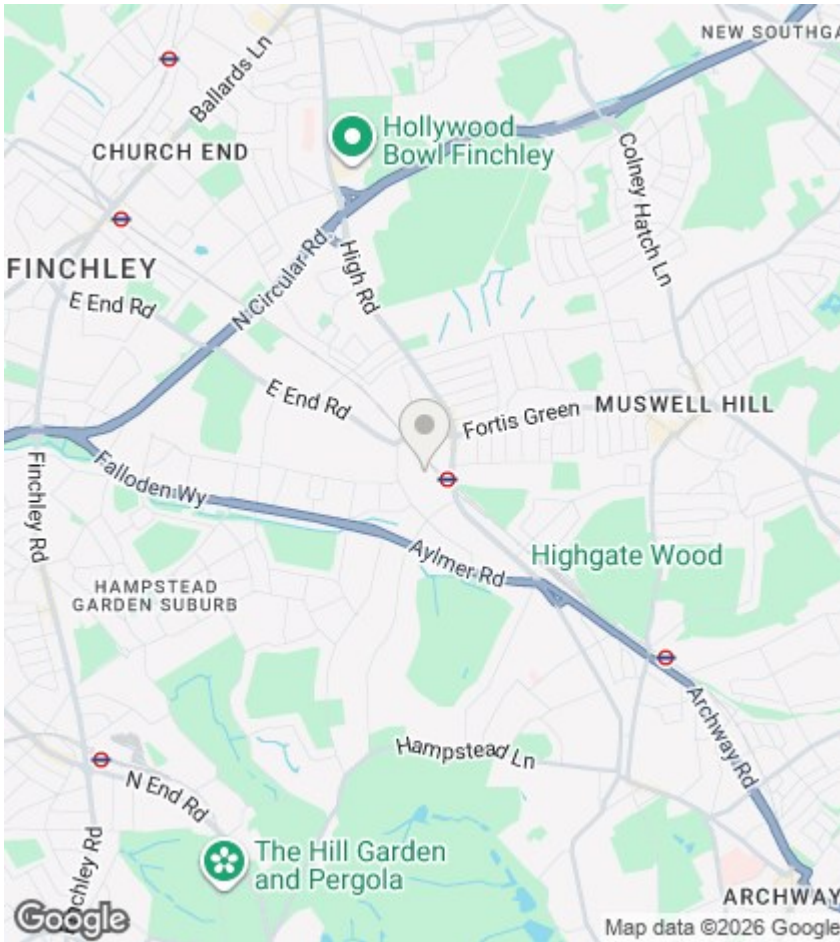

Directions

Viewings

Viewings by arrangement only. Call 020 8444 5222 to make an appointment.

Council Tax Band:

E

EPC Rating:

C

Energy Efficiency Rating		Current	Potential
Very energy efficient - lower running costs			
(92 plus) A			
(81-91) B			
(69-80) C		70	79
(55-68) D			
(39-54) E			
(21-38) F			
(1-20) G			
Not energy efficient - higher running costs			
England & Wales		EU Directive 2002/91/EC	

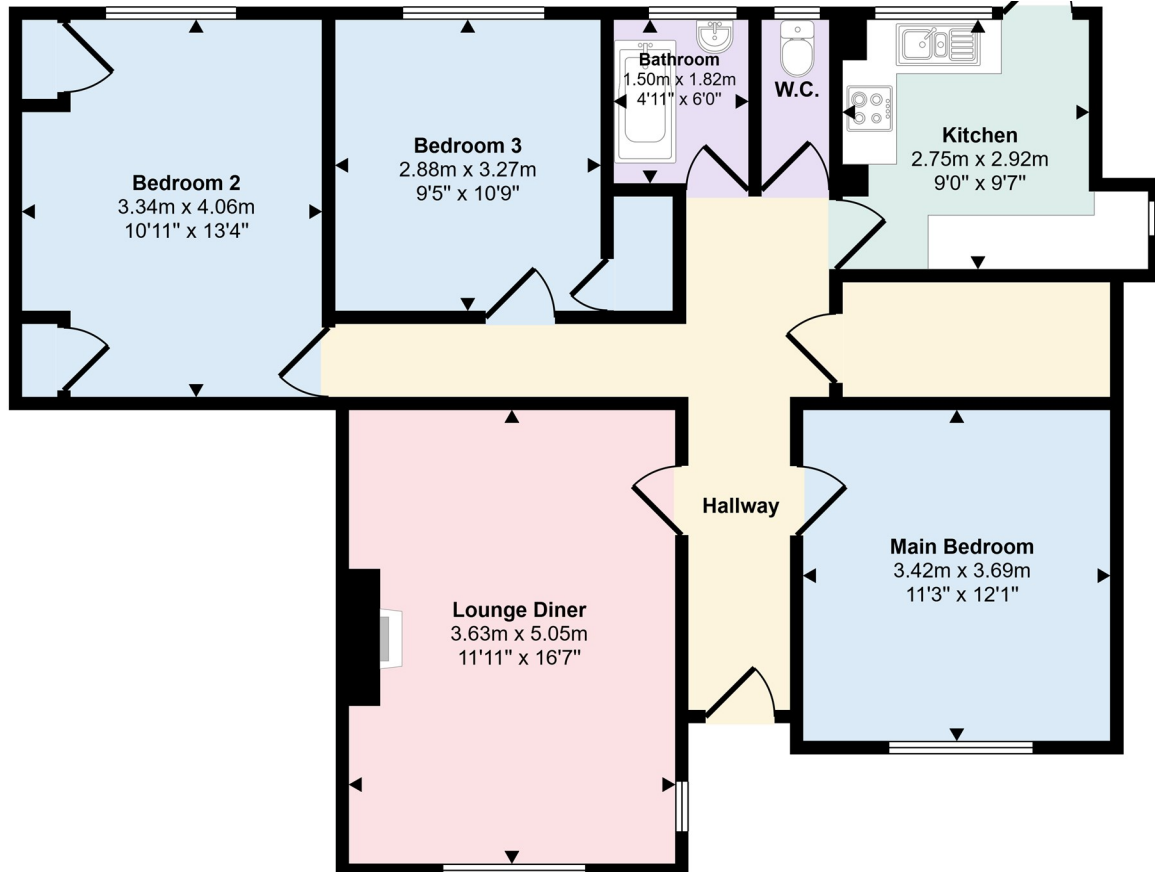

Floorplan